

Splice Shelves



Splice Shelves

FEATURES

- Perfect for displaying accessories in your new bathroom.
- Available in three practical sizes – 300mm, 450mm and 600mm with a standard depth of 200mm.
- Other sizes available on request (additional charges may apply).
- Includes hidden internal brackets for sturdy installation.

INSTALLATION INSTRUCTIONS

1. Studs / noggins must be provided for secure mounting.
2. Place bracket on wall making sure the arrow on the bracket body is pointing upwards and fasten brackets to the wall through the mounting holes provided.
3. Adjust bracket until level by turning the main stem and then tighten the grub screw at the rear base of the bracket to lock in place.
4. Squeeze some silicone into the mounting holes in the shelf and push shelf all the way on to the brackets.
5. Allow 24 hours to dry before using shelf.



Comes complete with two super sturdy mounting brackets.

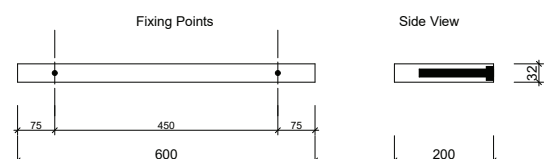
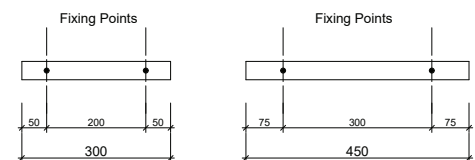
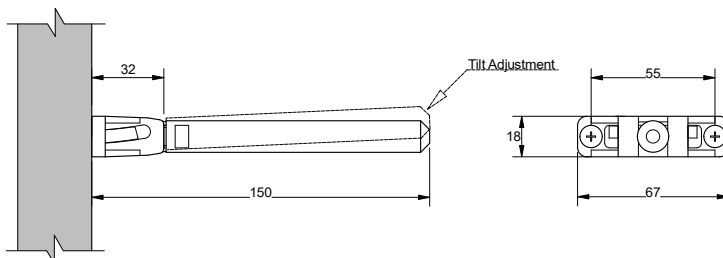

Custom Size Shelves Available Min Depth = 185mm , Max Depth = 250mm. POA. Weight Restrictions = 5kg.