

Cabinet Legs

Instructions

1. Print template at actual size.
2. Cut and place the drilling template in the corner of the cabinet.
3. Mark out the holes using a marker.
4. Pre-drill holes.
5. Attach leg by using the screws provided.
6. Repeat steps 2-5 for remaining legs.

Round Leg Template

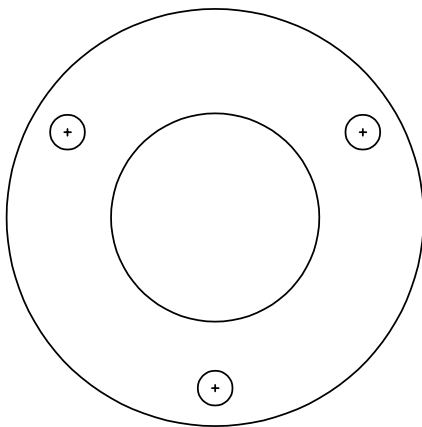

Round

Legs can be adjusted within 150mm – 166mm height.

Square Leg Template

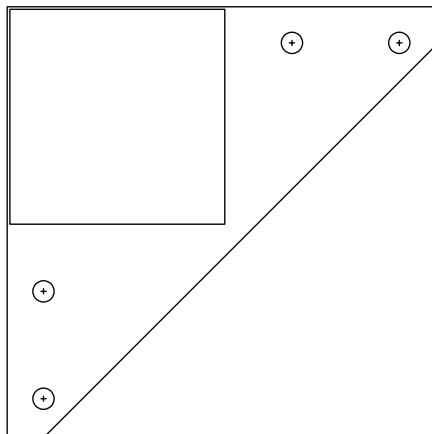

Square

Legs can be adjusted within 150mm – 166mm height.

Arrow Leg Template

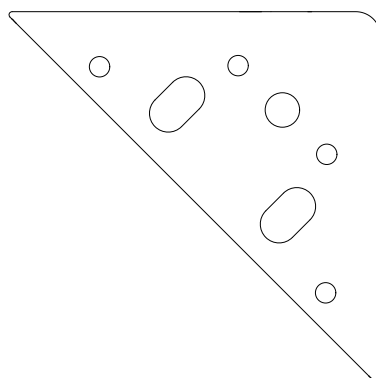

Arrow

Available in 150mm.

NOTE: Cabinet must be mounted to wall. Legs are for decorative purposes only and tall boys and vanities must be fixed to the wall. Use appropriate hardware for the type of wall and ensure they are rated for the weight you intend to bear.



Edge Leg Template

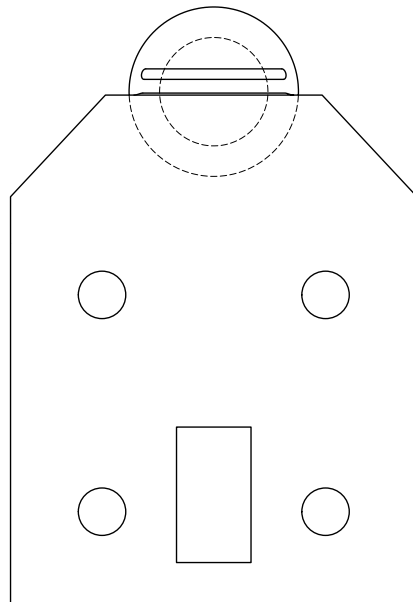

Edge
Available in 200mm.

Straight Leg Template

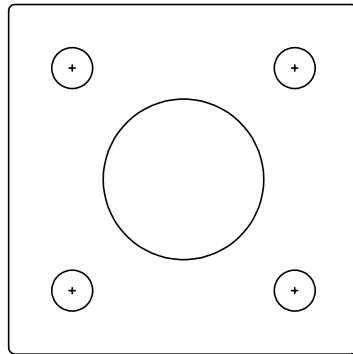

Straight
Available in 150mm.

Angled Leg Template

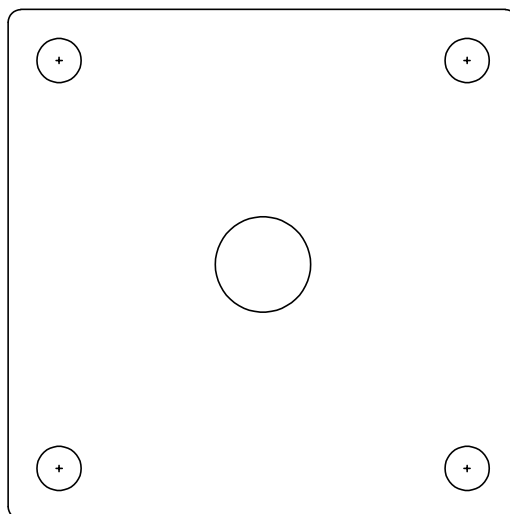

Angled
Available in 200mm.

NOTE: Cabinet must be mounted to wall. Legs are for decorative purposes only and tall boys and vanities must be fixed to the wall. Use appropriate hardware for the type of wall and ensure they are rated for the weight you intend to bear.